

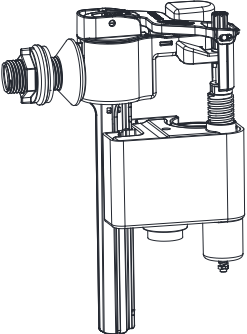

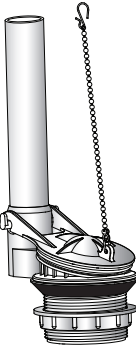



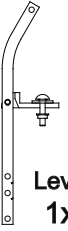

### Parts supplied:

|  |  |   |  |   |   |
|--|--|---|--|---|---|
| <br><b>Inlet Valve</b><br><b>1x</b> | <br><b>Flush Valve</b><br><b>1x</b> | <br><b>Handle</b><br><b>1x</b> | <br><b>Lever</b><br><b>1x</b>        | <br><b>Spring</b><br><b>1x</b> | <br><b>Flush Cone</b><br><b>1x</b>     |
|  |  | <br><b>Cover</b><br><b>1x</b>  | <br><b>fixing block</b><br><b>1x</b> |   | <br><b>Plastic Washer</b><br><b>1x</b> |
|  |  |   |  |   | <br><b>Cone Washer</b><br><b>1x</b>    |
|  |  |   |  |   | <br><b>Fixing Nut</b><br><b>1x</b>     |

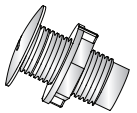
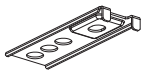
- Please read these instructions carefully to avoid damage to the valves, and to ensure correct installation.
  - Do not use bleach or bleach based cleaning products in the cistern, as these will cause damage to the seals.
- We cannot be held responsible or liable for any failure which results from the use of bleach based products.
- Water temperature range +2C to +45C.
  - Water pressure 0.2 to 8 bar.

### 1: Inlet Valve installation and adjustment settings

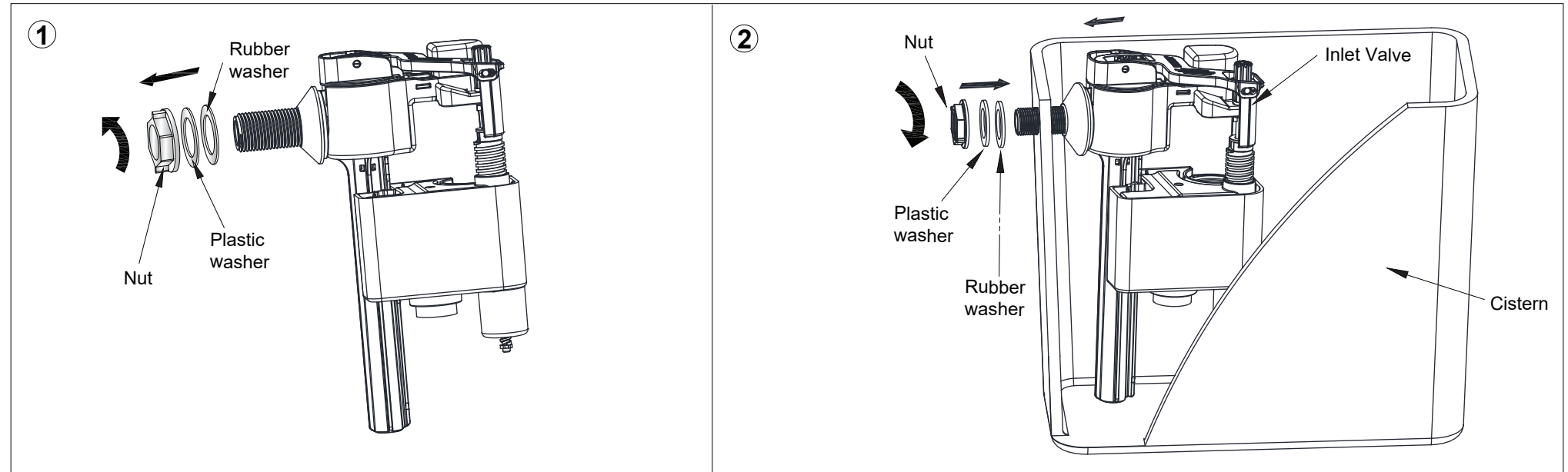

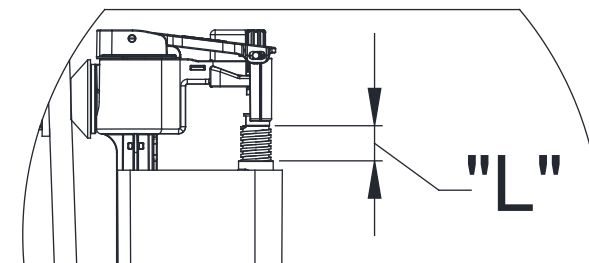
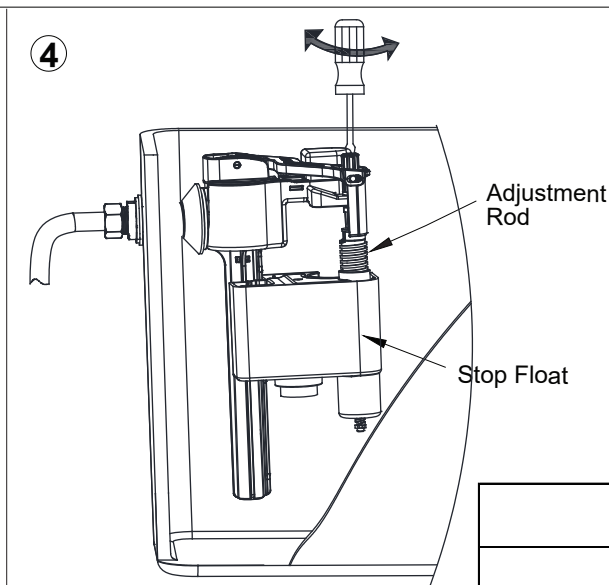
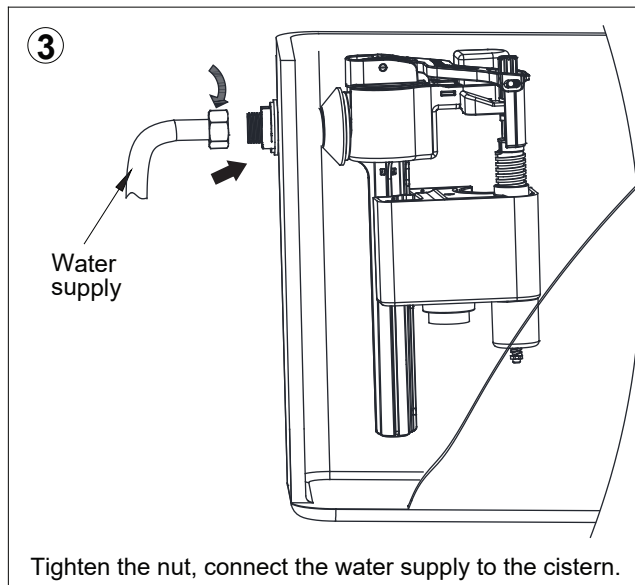

**Adjustment the rod:**

A: By adjusting clockwise the water level rises and flush volume increases.

B: By adjusting anti-clockwise the water level falls and the flush volume decreases.

| Item | L (mm)<br>6L full flush | L (mm)<br>4.5L full flush |
|------|-------------------------|---------------------------|
| C28S | 47                      | 67                        |

## 2: Filter cleaning (Please clean periodically)

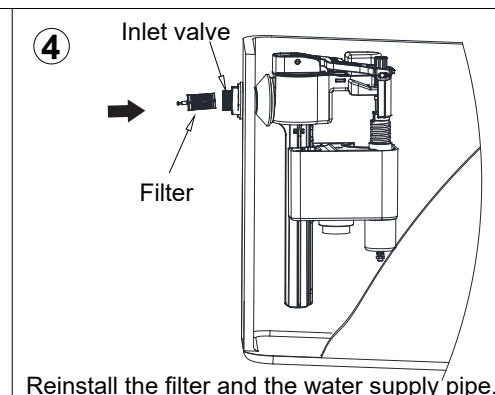
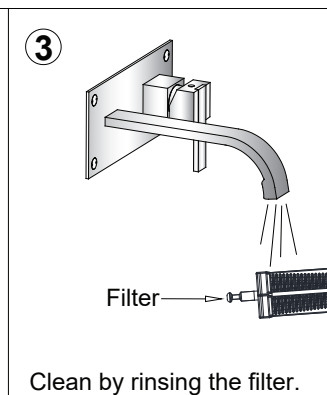
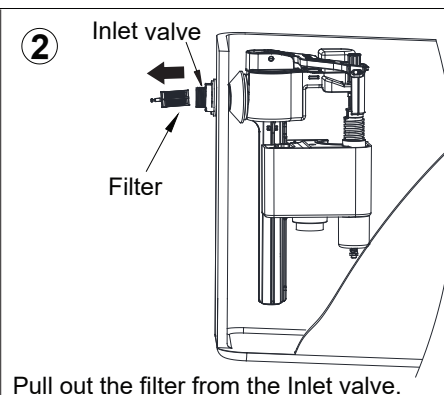
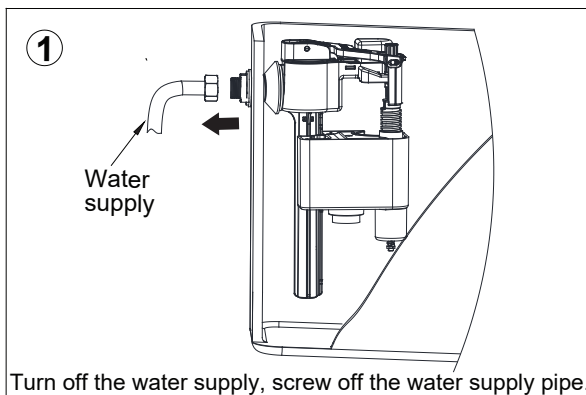

## 3: Inlet Valve trouble shooting

| Problem                   | Reason  | Solution   |
|---------------------------|---|--|
| Incorrect water level     | Incorrect adjustment.   | Adjust the Water level correctly as per diagram above. |
| Inlet Valve does not work | Water supply is closed.   | Open the water supply                                  |
|                           | The filter is blocked.  | Clean the filter.                                      |
|                           | The Stop Float has been over adjusted beyond its operational range. | Adjust the adjustment rod.                             |
| Leakage                   | The Inlet Valve fixing nut has not been tightened.                  | Tighten the nut.                                       |

# Flush Valve Installation And Problem Solving

## 1: Flush Valve installation

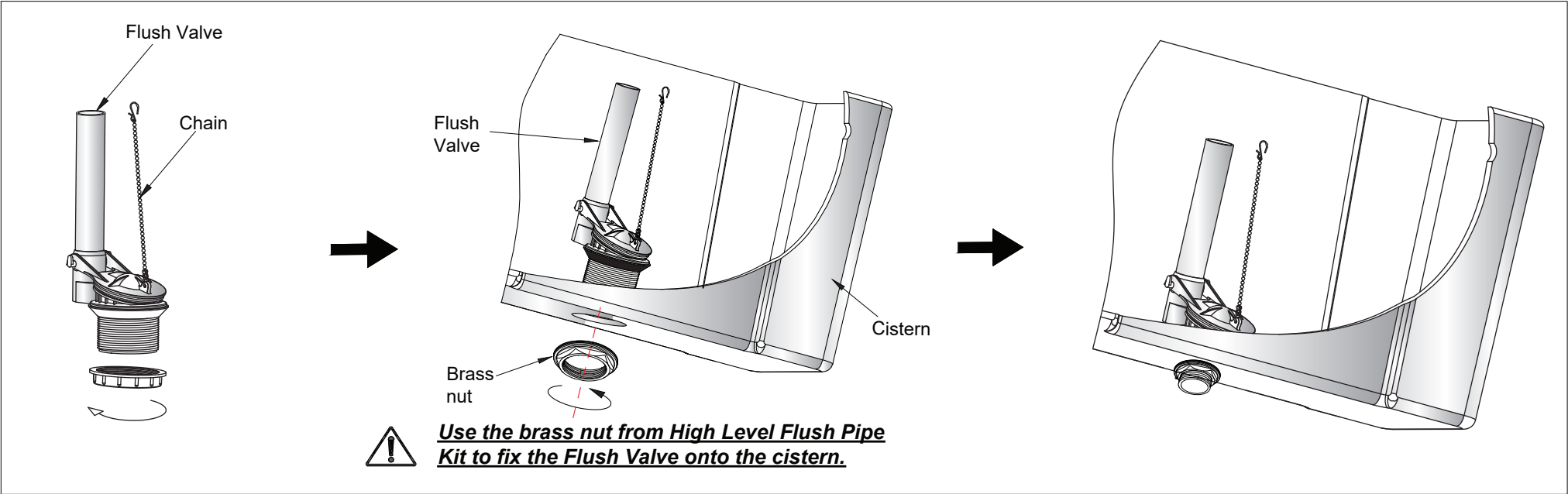

## 2: Flush Valve Cleaning

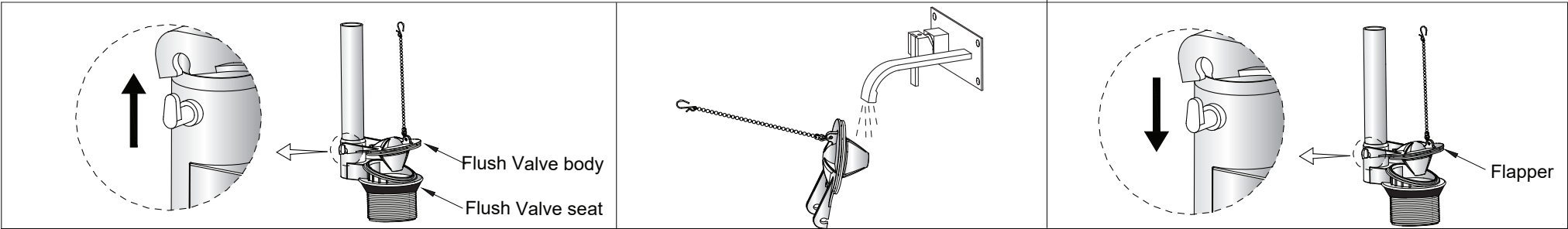

## 3: Flush Valve trouble shooting

| Problem                                  | Reason  | Solution   |
|--|---|--|
| Leakage                                  | 1.Incorrect installation.<br>2.Flush valve body is stuck.<br>3.Chain is too short.<br>4.The flapper doesn't adhere to the flush valve seat. | 1.Install again according to the correct installation procedure.<br>2.Unpick and wash flush valve body.<br>3.Readjust the length of chain.<br>4.Install again. |
| No flush, low flush or half flush volume | Chain is too long.  | Readjust the length of chain.  |

# Flush Lever Installation

## 1: Install Flush Lever Onto Cistern

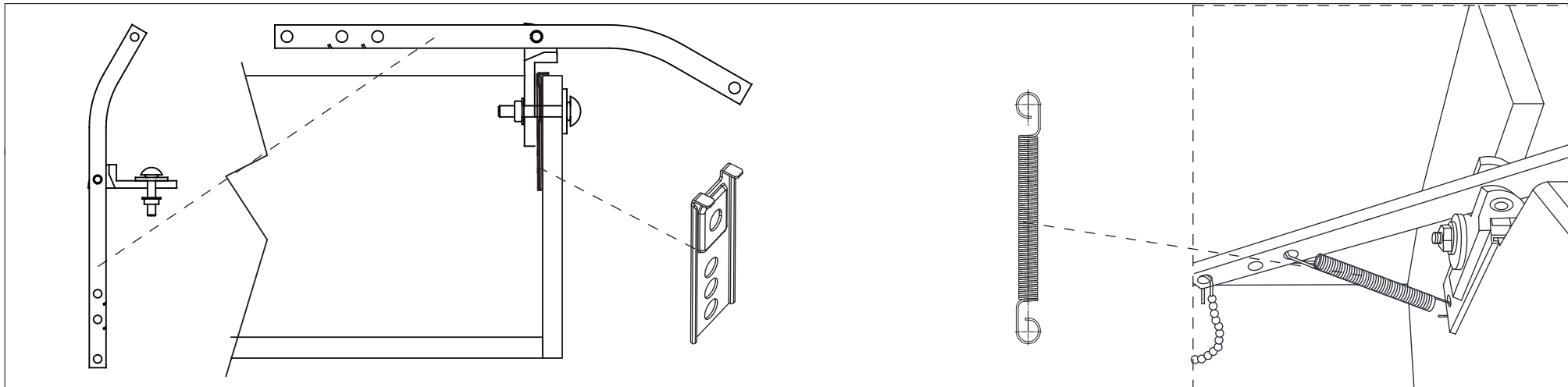

## 2: Connect Flush valve With Flush Lever

